

Mix Pro Underwater Scooter

USER MANUAL

Please read this User's Manual carefully
before operation and store it properly

V1.0

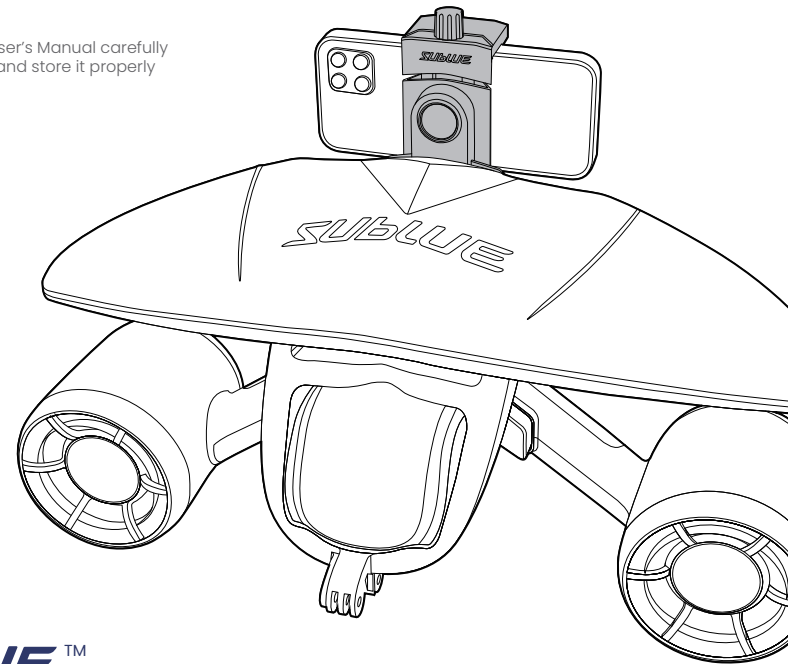

SUBBLUE Tianjin (Headquarters)

ADD. No.1,Quanzhou Road,Zhongguancun
Science and Tech.Park,Binhai Tianjin CHN

E-mail support@subblue.com

Web www.subblue.com

The final right of interpretation belongs to Subblue

SUBBLUE™

Recommendations and Support

1 Recommendations

When using this product for the first time, you are advised to read the “Mix Pro User’s Manual” for product information and instructions.

2 Support

Get support related to product issues, the user’s manual, and instructional videos, etc. via the following methods.

Website: <http://www.sublue.com>
Email: support@sublue.com

China:

Service hotline: 400-806-2688
Email: support@sublue.com



WeChat for
personal support



Official SUBLUE WeChat
public account

Dealers

For other regions, please contact your dealer for support.

Information on general regional agents

United States:

Service hotline: +1 855 206 8698
Email: support.us@sublue.com

Warning

Warning



This product cannot be used as a lifesaving device.



Be sure to read the User's Manual carefully before use, and be familiar with all operating methods and precautions.



Ensure that a companion is watching you from within a certain distance during use.



This product is not recommended for use by children under the age of eight.



Before use, fully inspect the product to confirm that the battery is in good condition and its power level is sufficient. Confirm that the twin propellers and impeller are running and functioning normally.



Before use, fully understand the water area you want to enter. Ensure that you are swimming or diving in an appropriate area, and that the water management authority agrees to use the product in that area.



Always pay attention to the surrounding water area during use to ensure no danger of collision with boats or swimmers.



To ensure safety, in all circumstances, users should either wear a life jacket or be equipped with life-saving equipment.



Always remove the battery from the product before transport or air transit, and store the battery separately in accordance with relevant regulations.



Under no circumstances should you put your fingers into the propeller, and do not affix clothing or other objects near the propeller.



Do not wear loose clothing or devices that could be sucked into the propeller by the water.



Wear a swimming cap during use, and pay special attention to anyone with long hair around you to prevent hair or clothing being tangled in the propeller.



Always pay attention to battery charge when using this product in water and make sure to return it before [power exhaustion].



Under no circumstances should your face or mask face the rear of the propeller.

Notes

- 1 Fully charge the battery before use.
- 2 Do not drink alcohol or take medication before or during use.
- 3 Try to use this product in open areas. For safety, don't let clothes, algae, ropes, shark nets, shells, sand, or other debris in the water become tangled in the propeller.
- 4 Do not replace the battery in water. Be sure to replace it in a dry environment where the device and hands are dry.
- 5 To protect the service life of the motor, do not run it continuously more than 30S in a non-water environment. In the case of any abnormalities (such as a burning smell), immediately release the switch to stop the machine and cut off the power supply.
- 6 Do not use this product directly on the beach so that sand, shells, or other debris are not brought into the propeller.
- 7 The surface of the product must not come into contact with volatile or acidic substances such as gasoline or thinner, or sharp objects.
- 8 Do not place heavy objects on the product.
- 9 Do not throw the battery into fire.
- 10 When the product is not in use, keep it away from direct sunlight. High temperature can damage the battery and can cause explosion or leakage.
- 11 Do not use this product beyond its specified limit depth (40m).
- 12 Ensure sufficient lighting in dark water or when diving at night.
- 13 This product is not intended for use in water with dissolved sand or with similar physical properties.
- 14 Do not use in the case of malfunction.
- 15 Factors such as location, temperature, depth, and water flow under different conditions can affect the buoyancy of this product. If the product is released at this time, it may sink.

- 16 Be sure to remove the product from the water when it is not being used.
- 17 After-sales service personnel except for the manufacturer may not perform repairs without authorization. Improper repair may result in water leakage, damage, fire, or electric shock.

Read and understand the user manual
and all other safety instructions
before using this equipment.



Contents

Product Overview	1
Information	1
Features	1
List of items	3
Part Names	4
Preparation before first use	5
Unpacking for inspection	5
Checking battery charge and charging it	5
Reading the User's Manual	6
Official use	6
Operating instructions	6
Operation	6
Description of indicator lights	8
Proper use	9
Proper grip and position	9
Turning in water	10
Sinking and rising	10

Installation and use of accessories	10
Flotation tank	10
Waterproof mobile phone shell holder	11
Wear and emergency release of loss prevention cord	13
Battery	14
Introduction to the battery	14
Battery charging	15
Battery replacement	15
Battery storage and maintenance	16
Maintenance	17
Cleaning after use	17
Storage	18
General troubleshooting	18
Appendix	20

Symbol Explanation: * Note (Detailed explanation)

 warning

©2019 SUBLUE Copyright

Product Overview

1 Information

Mix Pro is a new underwater booster from Subblue, used by diving, swimming and water lovers all over the world. It builds on the advantages of White Shark Mix, and its compact body has excellent capabilities. Both sides are equipped with balanced and efficient self-developed propeller propulsion systems. Both speeds can be changed freely. Mix Pro can enable even novice swimmers to swim like stars. In addition, it is equipped with a waterproof mobile phone shell holder, so that you can use your phone underwater to shoot the beautiful scenery and the exciting sports moments.

2 Features

- **Compact and portable**

It is about 60% lighter than traditional DPVs, and its compact body is convenient for travel.

- **Ready to use**

Press the switches on both sides to start. One-side release will stop the product, making it easy to swim underwater.

- **Two-level speed change**

Switch between high and low speeds at any time to enjoy underwater experiences from free swimming to speed swimming.

- **Long service time**

Mix Pro uses an advanced DC brushless motor and technology to realize better performance and longer durability.

- **Removable flotation tank**

With the help of the removable flotation tank, the whole machine realizes micro-positive buoyancy* and automatically floats upwards after release.

- **Load extension**

A standard motion camera hanging point is found under the front of the product, and a mobile phone waterproof shell holder is provided so that phones can be taken underwater to shoot photos.

- Quick replacement of battery

The unique patented battery sealing technology enables quick battery replacement within 5 seconds, and ensures reliable underwater sealing.

* The micro-positive buoyancy of the frame plus flotation tank exists only when the product is in sea water and the user does not add additional objects with negative buoyancy (weights, underwater cameras, lighting equipment, etc.). Different water environments, additional load and use depth beyond normal value may change product buoyancy and even cause negative buoyancy.

3 List of items



Booster frame×1



Flotation tank×1



Charging adapter + power cord×1



Lithium ion battery×1



Loss prevention cord×1



Ring for external attachment×1

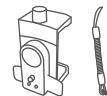

Waterproof mobile phone shell holder + phone loss prevention cord×1



Instructions ×3



1. Before use, check carefully whether the package includes the above items. If any items are missing, please contact Sublue or your dealer.
2. Check to see if the product is damaged.
3. This product package does not contain waterproof mobile-phone shell and mobile phone.

4 Part Names

1. Propeller sleeve
2. Protective cover
3. Flotation tank
4. Hanging point
5. Grip
6. Control compartment
7. Suction disc

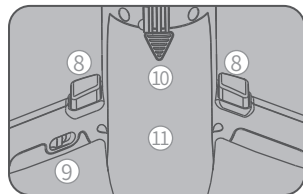
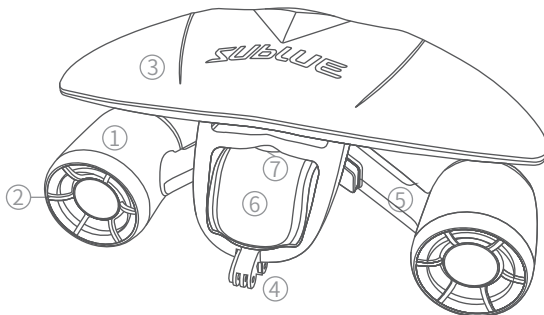

8. Start button
9. Security lock
10. Rear battery cover
11. Battery compartment

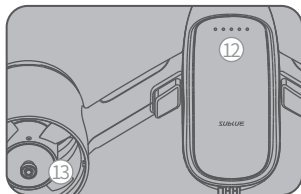

12. Status Indicator
13. Propeller



Preparation before first use

1 Unpacking for inspection

• Checking device appearance

After unpacking, check carefully whether the shell is broken, the protective cover has fallen off, the propeller blade has been damaged, the battery back cover cannot be opened, the battery is swollen or is leaking, the battery sealing pad has been damaged, or other conditions that could seriously affect product use.

• Checking function

Check whether the left and right start buttons are stuck or broken, and after starting check whether the left and right propellers are running normally with normal speed changes.

! If you find any of the above problems, please do not use the device and contact a Subblue After-sale Service Center or an authorized after-sales service organization. Do not run the device for more than 30 seconds without water.

2 Checking battery charge and charging it

Connect the charger to the AC supply (100-240V AC, 50/60Hz)

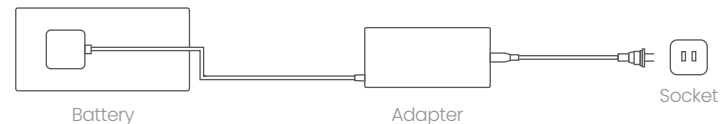

! When charging, make sure that the positive and negative signs of the charging plug match those of the battery.

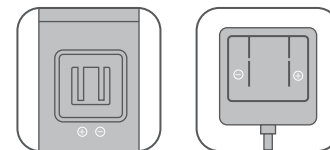

③ Reading the User's Manual

Before use, carefully read this User's Manual and become familiar with operation processes and instructions.

④ Official use

Use your Mix Pro to explore the underwater world.

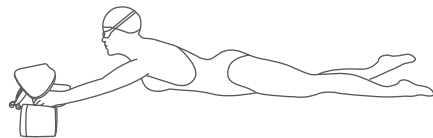

 Before use, you should be familiar with product performance in an absolutely safe water environment and fully grasp its operations.

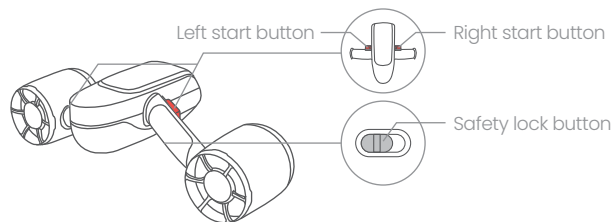

Operating instructions

① Operation

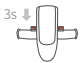
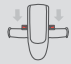
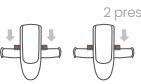

Item	Instructions	Photo	Remarks
Power on	Press and hold the left start button for 3 seconds. The device will be on after the indicator light turns on.		The initial start speed is "low" by default.
Operation	With the device turned on, press the left and right start buttons at the same time to run it.		LED indicator is on and solid.
Changing speed level	1. Press the left and right start buttons at the same time to run the device. 2. Double press the right-hand start button quickly, then press and hold it		The double-press interval is about 0.5s. Cycles between high and low speeds.
Stop (stand-by)	Release the left and right start buttons at the same time, or release a start button on either side to stop the device.		Enters standby mode, and LED indicator flashes.
Locking	Turn the security lock knob below the right handle of the device to the lock symbol.		The start button on the right side of the device cannot be pressed after locking.
Shutdown	When the device is powered on, it automatically shuts down after 10 minutes without button operations.		LED lamp off

 When you stop using the device or put it down, it is recommended to lock it to keep it in a safe state, and to prevent it from being inadvertently started due to contact with the start button, causing potential personal injury or damage to equipment.

2 Description of indicator lights

The Mix Pro body contains LED indicators showing status and battery capacity. Their location and definitions are as follows.

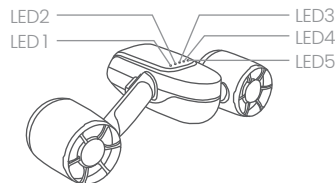

◻ Indicates that the LED indicator is flashing regularly

○ Indicates that the LED indicator is on and solid

● Indicates that the LED indicator is off

1. Checking battery level

Battery level indicator

LED1	LED2	LED3	LED4	LED5	Current level
○	○	○	○	○	70%-100%
○	○	○	○		50%-70%
○	○	○			30%-50%
○	○				20%-30%
○					Below 20%

! As the power level indicators successively go out from the right side of the device, pay attention to the battery change and return the device accordingly.

2. Status indicators

◻◻◻◻◻	Flashing LED indicator with varying colors	Power on	
●●●●●	All LED indicators are off	Shutdown	
◻◻◻◻◻	Breathing flashes	Stand-by	Low speed: violet High speed: orange
○ ○ ○ ○ ○	LED indicators are on and solid	Running	Low speed: violet High speed: orange
◻◻◻◻◻×1	LED lamp flashes once	Low battery level alarm	The indicator is red
◻◻◻◻◻×3	LED lamp quickly flashes three times	Very low battery level alarm	The indicator is red

Proper use

! Familiarize yourself with performance of this device in an absolutely safe water environment, and fully grasp the operations before use.

1 Proper grip and position

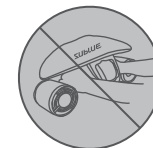
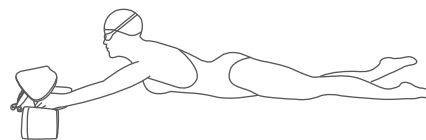

2 Turning in water

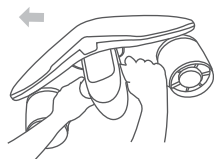

Turn left

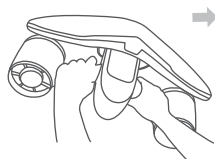

Turn right

3 Sinking and Rising

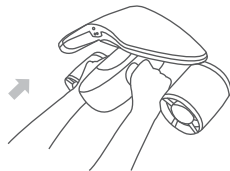

Rising

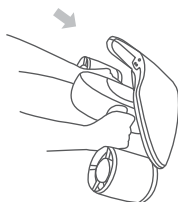

Sinking

! If you have not studied diving or received professional training, to prevent bodily harm, do not use the device to sink or rise too quickly.

Installation and use of accessories

1 Flotation tank

The device includes a flotation tank, allowing the entire fixture to realize positive buoyancy. It automatically floats upwards after release. You can select flotation tanks based on the actual situation.

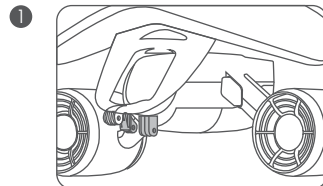

Align the flotation tank suspension point with that of the equipment body

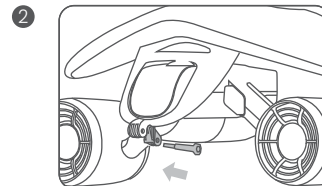

Insert the screw (which does not need to be tightened, just insert it)

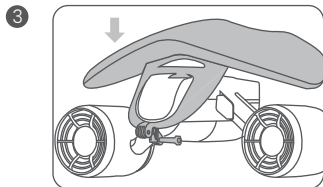

Press the buoyancy force toward the equipment body to make the sucking disc on the flotation tank suck the equipment body

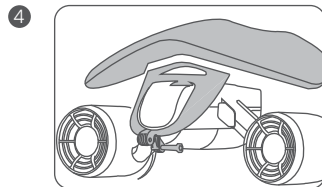

Tighten the screws and the flotation tank is assembled

* The micro-positive buoyancy formed by the device plus the flotation tank exists only when the product is in seawater, and the user does not add additional objects with negative buoyancy (weights, underwater cameras, lighting equipment, etc.). Different water environments, additional loads and use depth beyond normal value may change product buoyancy and even cause negative buoyancy.

! Use of the flotation tank is limited to water depths less than 5 meters.

② Waterproof mobile phone shell holder

The device includes a mobile phone waterproof shell holder, to be used with waterproof mobile phone shells, allowing phones to be taken underwater to shoot photos. The holder can be installed or not according to your needs.

1. Rotate the holder right or left to the horizontal position.

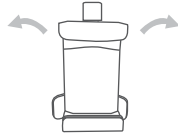

2. Align the two range limiters ① on the back of the mobile phone waterproof shell holder with the limit hole ② at the back of the flotation tank and insert them. After inserting the screw ③, tighten it by hand or with a screwdriver.

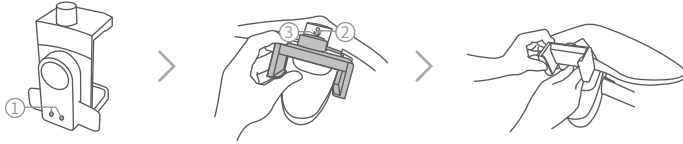

3. Turn the knob nut of the holder ④ counterclockwise to open the clip to the proper position. Insert the waterproof shell with the mobile phone, then tighten the nut ④ clockwise so that it does not fall off.



4. Rotate the holder to a horizontal or vertical position depending on your shooting needs.

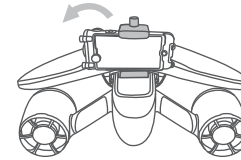

5. Finally, connect the waterproof mobile phone shell to the flotation tank with the mobile phone shell loss prevention cord ⑤.

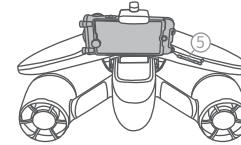

1. The waterproof shell holder does not keep the phone sealed under water. Therefore, ensure that the mobile phone has independent and reliable sealing protection before use, and follow the corresponding instructions.
2. Use appropriate force while tightening the nut. Excessive force may damage the waterproof shell or mobile phone, causing unnecessary trouble and loss.

* The waterproof shell holder must be used with the flotation tank and is purchased separately.

③ Wear and emergency release of loss prevention cord

The equipment includes an anti-loss cord. One end of it is connected to the device grip, while the other is connected to the wrist on the same side. The cord can be used to make sure the device is not lost in the water due to water flow or other reasons.

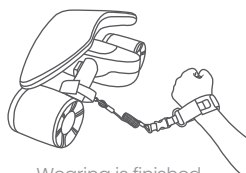

Wearing is finished



Quick release

! While wearing the loss prevention cord, in order to protect your personal safety in case of emergency, the device can be separated from you by quick release.

Battery

1 Introduction to the battery

The battery is a high-performance lithium-ion battery with a capacity of 11,000 mAh, designed specifically for the Subblue™ Mix Pro underwater booster. It features high-performance cells that provide sufficient power supply for the Mix Pro.

- !**
1. The battery must be charged using the dedicated charger supplied by Mix Pro. Subblue is not responsible for any consequences of charging through chargers not provided by the official Mix Pro product (including other Subblue models).
 2. The Mix Pro is powered by a Li-Ion battery, so be sure to fully charge the battery before using it for the first time.
 3. If the five indicators are red and flash continuously while the device is powered on, it indicates that the battery level is low. Charge it promptly.
 4. It takes about 2 hours to fully charge the battery.

2 Battery charging

Connect the charger to the AC supply (100-240V AC, 50/60Hz).

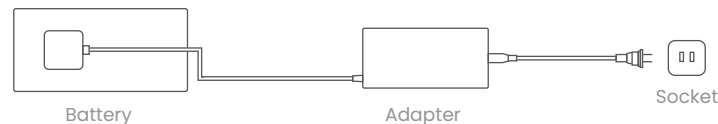

! When charging the battery, note that the positive and negative signs of the charging plug must match the direction of those on the battery.

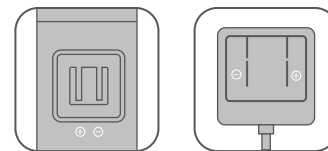

3 Battery replacement

When the battery is installed correctly and secured, you will hear a click. Confirm that it is installed securely (as shown below).

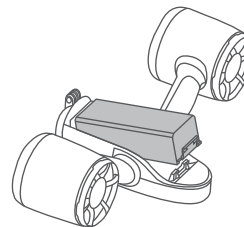

Before installation of battery

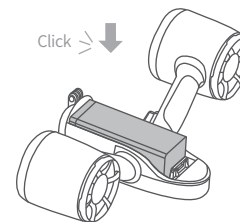

After installation of battery

4 Battery storage and maintenance

- 1 When the device is not in use, take the battery out and store it separately.
- 2 The optimal storage conditions for the battery are 0-25°C, 60 ± 25% RH humidity, and 30%-50% power capacity. It should be separately stored in a cool and ventilated place.
- 3 Do not leave the battery in places exposed to direct sunlight or high temperatures (such as near microwaves or ovens), because it may overheat and potentially explode.
- 4 Do not throw the battery into fire, otherwise it may catch fire or explode.
- 5 Do not charge the battery near fire or heat.
- 6 Do not drop, squeeze or puncture the battery as this may cause internal short circuiting and overheating.
- 7 Do not disassemble or modify the battery. Unauthorized modification may cause leakage or explosion.
- 8 Keep the battery out of the reach of children.
- 9 Do not charge the battery below 0°C.
- 10 When the battery is used below 0°C, its charge drops sharply and operating time is drastically reduced.
- 11 For safety, the battery should be kept at low charge during transportation. Discharge it beforehand to 30%.
- 12 Do not use damaged batteries.
- 13 If electrolyte enters your eyes after leakage, do not wipe it. Apply water to rinse it, and consult a doctor immediately. If left untreated, your eyes will be injured.
- 14 If stored for a long period, check the battery level at least every 3 months and charge it to 60%.

Maintenance

1 Cleaning after use

- 1 After each use, Mix Pro should be completely immersed in clear water for 30 minutes to prevent residue from seawater or foreign matter. Also pay attention to the following points.

- * The battery must be installed during cleaning.
- * Use clean water.
- * Immerse in water for more than 20 minutes
- * Do not add chemical cleaners such as laundry detergents or cleaning agent to the water.
- * When the Mix Pro is immersed in water, some bubbles may emerge from holes on its body. This is not abnormal.

- 2 Press both switches so that the Mix Pro runs half in air and half in water for 3 seconds. Repeat 5-10 times.

- * To prevent the water from being splashed on your body during operation, push the propeller outlet to the bottom of the container.
- * Mix Pro has a large thrust force in the water. Use low speed, and life the device slightly out of water surface for cleaning, for easier control (as shown below)

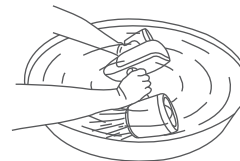

- 3 Shake fully and clean the Mix Pro body to remove any foreign matter attached to it.
- 4 Wipe the surface of the device with a clean, soft, dust-free cloth. Make sure that the body and battery have no water beads, and place them in a cool, dry place to dry naturally.

- * Never use a hair dryer or drying apparatus to dry it.

2 Storage

If you are not going to use the device for a long time, please note that the Mix Pro and the battery should be stored separately in the package. Follow the following principles.

- 1 Ensure that the device is stored in a cool and ventilated place, above 0°C and below 50°C.
- 2 Don't store it in areas with poor ventilation or humidity above 65%
- 3 Don't store it in areas exposed to direct sunlight.
- 4 Keep it away from heat, fire, and children's reach.
- 5 Keep it away from devices that may generate strong magnetic fields.
- 6 Take out the device at least once a month and run it for about 10 seconds to prevent corrosion caused by changes in the storage environment.

General Troubleshooting

Fault	Solution
Failure to start	<ol style="list-style-type: none">1. Check if the battery has power2. Check if the device can be powered on3. Check if the battery power capacity indicator is on4. Check if the propeller can be rotated5. Contact Subblue or an authorized service organization
Stuck or abnormally running propeller	<ol style="list-style-type: none">1. Remove the battery2. Check if the propeller is entangled in foreign matter3. Follow the instructions in the "Clean after use" section in "Maintenance"4. Contact Subblue or an authorized service organization

Abnormal LED indicators

1. Check if the battery has power
2. Contact Subblue or an authorized service organization

Battery contact is dirty

1. Check for damage around the battery contacts
2. Check the device's sealing gasket for damage or protrusions
3. If the stain is slight, clean it with a dry cloth and try applying vaseline on the battery contacts.
4. Contact Subblue or an authorized service organization

Speed levels cannot be changed normally

1. Check if the left and right start buttons are stuck
2. Contact Subblue or an authorized service organization

Damaged or swollen battery

Contact Subblue or an authorized service organization

Abnormal battery charging

Contact Subblue or an authorized service organization

Battery back cover is installed abnormally or cannot be removed

1. Check if the battery is installed correctly
2. Check if it is swollen
3. Check if the triangle button can be pressed and released normally
4. Contact Subblue or an authorized service organization

Appendix

Specifications and parameters

Device	
Dimensions	L465mm × W230mm × H230mm
Weight	3550g (including battery and flotation tank)
Working depth	40m
Speed levels*	high 1.8m/s; low 1.2m/s
Service time	up to 60m for normal use* (Up to 20m for high speed and 30m for low speed for continuous use*)
External load	support to carry motion camera, flotation tank, and mobile phone waterproof shell holder
Ambient operating temperature	0-35℃
Storage environment temperature	0-45℃
Battery	
Capacity	11000mAh
Nominal voltage	11.1v
Weight	890g
Capacity	121.1Wh
Ambient temperature for charging	5-40℃
Maximum charging power	100w
Charging time	≤2 hours
Mobile phone waterproof shell holder	
Dimensions	L52mm × W72mm × H105mm
Holding range	68mm-118mm

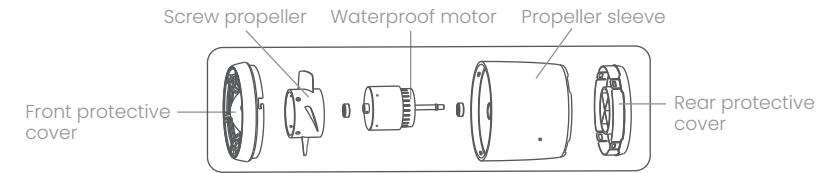

Motor parameters	
Rated voltage	12.6V
Power	500W
Motor grade	B continuous operation
Maximum speed	3400 RPM
Charging adapter	
Input voltage	100-240V~AC 50/60Hz
Output voltage	12.6v
Output current	6A
Charging indication	Charging: red; Fully charged: green

* The speed level is the experimental speed. The speed of navigation is affected by factors such as different users, water temperatures, water depth, flow, and other water conditions, as well as load on the device and the user's underwater wear and equipment.

* The use time generally is experimental data, and refers to the average maximum time of operation based on general (non-continuous) usage habits when the device is fully charged.

* Continuous use time refers to the average maximum operation time for continuous use at each speed level when the device is fully charged.

Names and Contents of Harmful Substances in Products

	Harmful substance									
	Pb	Hg	Cd	Cr6 (VI) Hexavalent chromium	PBB Polyb- rominated biphenyl	PBDE Poly- brominated diphenyl ethers	DIBP Diisobutyl phthalate	DEHP Di (2- et- hylhexyl) phthalate	BBP Tolyl Butyl Phthalate	DBP Phenylbutyl terephtha- late
Circuit board assembly	0	0	0	0	0	0	0	0	0	0
panel	0	0	0	0	0	0	0	0	0	0
Plastic (glue) parts	0	0	0	0	0	0	0	0	0	0
Metal parts	0	0	0	0	0	0	0	0	0	0
Power cord	0	0	0	0	0	0	0	0	0	0
Adapter	0	0	0	0	0	0	0	0	0	0
Charging seat	0	0	0	0	0	0	0	0	0	0
Battery	0	0	0	0	0	0	0	0	0	0
Other ac- cessories	0	0	0	0	0	0	0	0	0	0

This form is prepared according to SJ/T 11364.

O: Indicates that the content of the hazardous substance in all homogeneous materials of the component is below the limit specified in GB/T 26572;

X: Indicates that the content of the hazardous substance in at least one homogeneous material of the component exceeds the limit requirements specified in GB/T 26572.

Note: This product uses the concept of environmental protection design to effectively control harmful substances. The harmful substances indicated by "X" are mainly limited by the level of technological development and cannot be replaced by harmful substances.

Environmental protection service life:

This logo refers to the period of time (10 years) during which harmful substances contained in electronic and electrical products will not leak or mutate under normal use conditions, and users will not cause serious pollution to the environment or serious damage to their personal and property when using the electronic and electrical products.



Exhaust gas recovery tips:

In order to better care and protect the earth, when users no longer need this product or the product's service life ends, please abide by the relevant laws and regulations of the national waste electrical and electronic products recycling, and hand it over to the local manufacturer with the national recognized recycling qualification for recycling.

SUBLUE Technical Support
<http://service.sublue.com>

www.sublue.com

The information, diagrams and illustrations in this user manual are owned by SUBLUE. Copying and distributing without prior consent is strictly prohibited. SUBLUE reserves the right to change any information in this user manual.

This manual is subject to change without notice.

Check the latest version of this User's Manual in the "Service Support" section of the Sublue website.

If you have any questions or suggestions about the user manual, please contact us at the following email address.

support@sublue.com

